



## 155-157 Hovell Street Cootamundra NSW

3 1 4

Flemings Cootamundra are pleased to present 155-157 Hovell Street, Cootamundra to the market for sale. Set on a huge 2,023sqm block, this beautiful weatherboard home has been immaculately cared for by its original owners and now offers purchasers a great opportunity to add their own touches to create a beautiful character home or investment.

### Features include:

- 2,023sqm fully fenced block
- Three large bedrooms
- Large 4 bay shed with a workshop, plus an additional smaller shed/workshop and a wood shed
- Large family room opening onto a dining area and adjacent kitchen
- Separate lounge room
- Ducted evaporative cooling & gas heating
- Renovated bathroom with separate shower and bath

**Land Size** : 2023 sqm

**View** : <https://www.flemingspropertyservices.com/sale/nsw/riverina/cootamundra/residential/house/7086614>

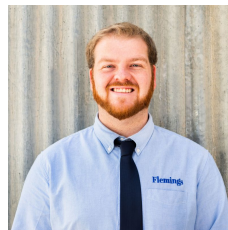

**Nick Ashe**  
02 6942 2480



**Chris Ryan**  
02 6942 2480

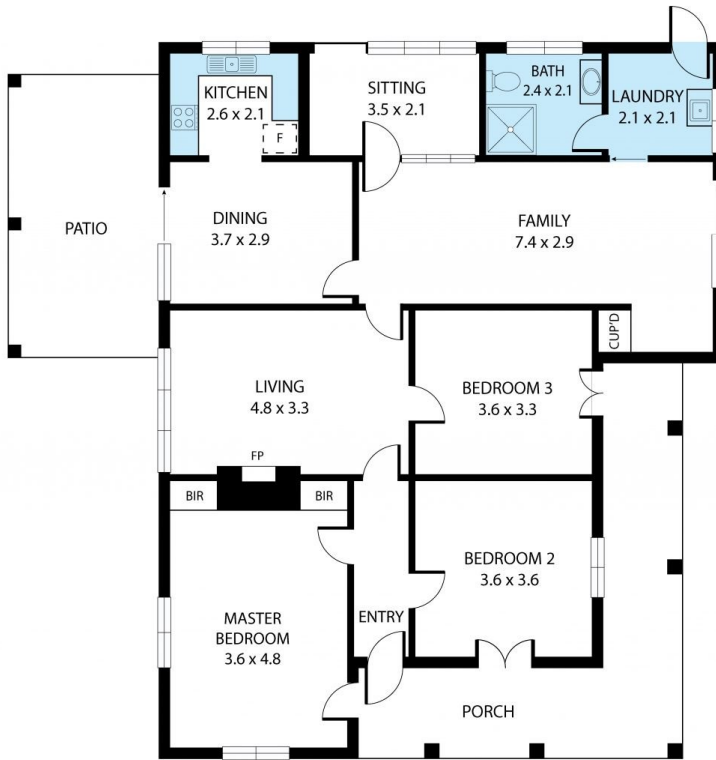

155-157 Hovell Street, Cootamundra 2590

TOTAL APPROX. FLOOR AREA 126 SQ.M

Whilst every attempt has been made to ensure the accuracy of the floor plan contained here, measurements of doors, windows, rooms and any other items are approximate and no responsibility is taken for any error, omission, or misstatement. This plan is for illustrative purposes only and should be used as such by any prospective purchaser.

**Flemings**