

Flemings



834 Henry Lawson Way Young NSW

3 1 6

Flemings Young are proud to present 'Pindari' 834 Henry Lawson Way, Young to the market for sale. Boasting a modest three bedroom brick veneer home, this property is situated under 10km from Young's CBD on 15.21 hectares (37.5*acres) and is complemented with amazing panoramic views.

- Three good sized bedrooms
- Formal dining & large lounge room
- Sun drenched family room
- Covered pergola entertaining area overlooking old tennis court
- Ducted evaporative cooling
- Three bay metal garage with workshop space
- Four bay machinery shed with power
- Three stables
- 30,000 Gallon fresh water storage

Land Size : 15.21 ha

View : <https://www.flemingspropertyservices.com/sale/nsw/capital-monaro-snowy/young/residential/acreagesemirural/6884043>

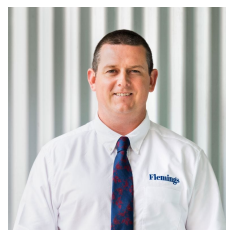

Mat Mcknight
02 6382 3883



Nick Duff
02 6382 3883

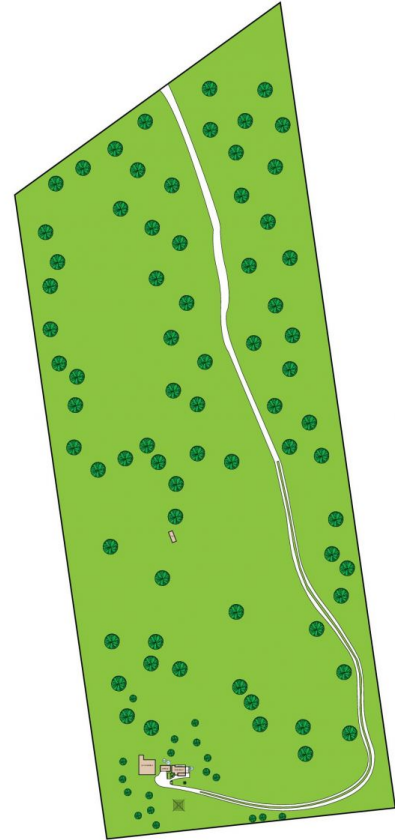
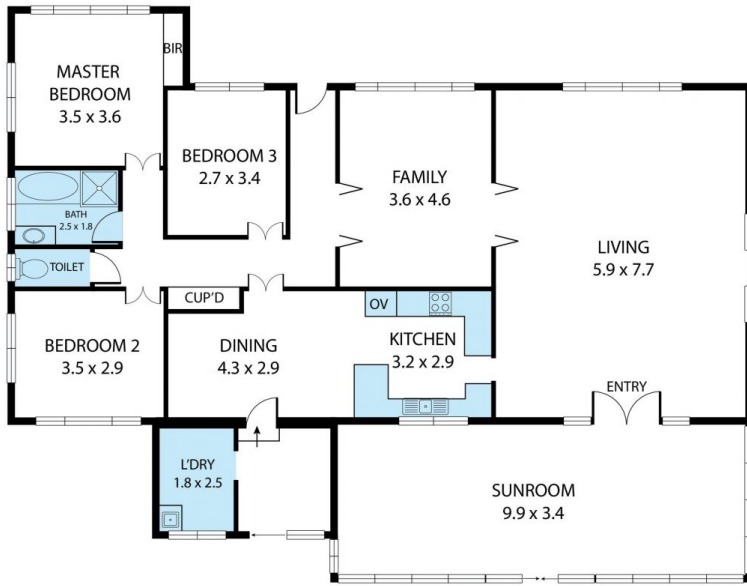

Pindari, 834 Henry Lawson Way, Young 2594

TOTAL APPROX. FLOOR AREA 196 SQ.M

Whilst every attempt has been made to ensure the accuracy of the floor plan contained here, measurements of doors, windows, rooms and any other items are approximate and no responsibility is taken for any error, omission, or misstatement. This plan is for illustrative purposes only and should be used as such by any prospective purchaser.

Flemings